

ITEM	DESCRIPTION	MATERIAL	QTY.
1	MDC PART# 110037	AISI 304	1

DIMENSIONS QUOTED ARE FINISHED DIMENSIONS, NO ALLOWANCE HAS BEEN MADE FOR MANUFACTURE.

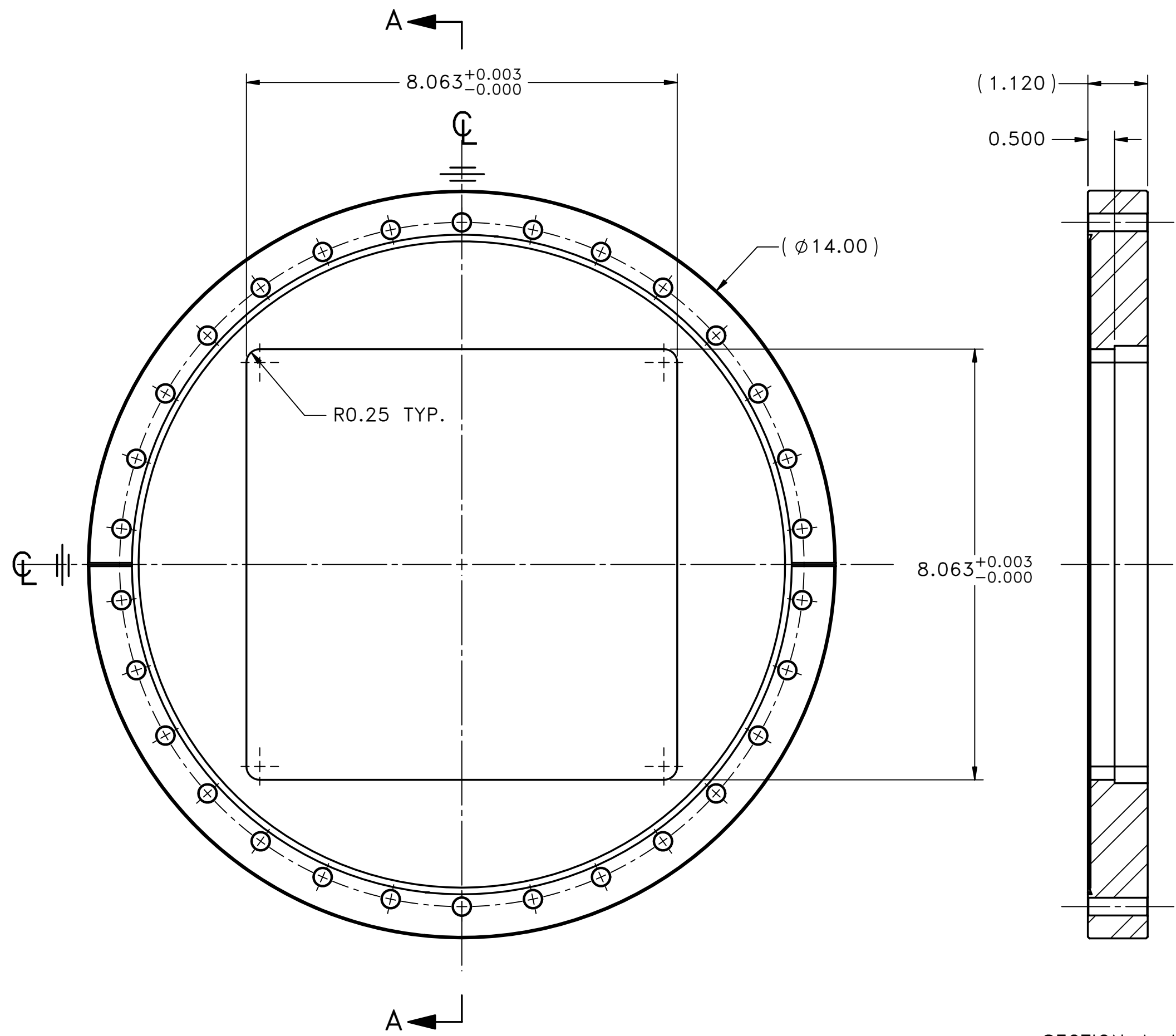

SECTION A-A
SCALE 1 : 2

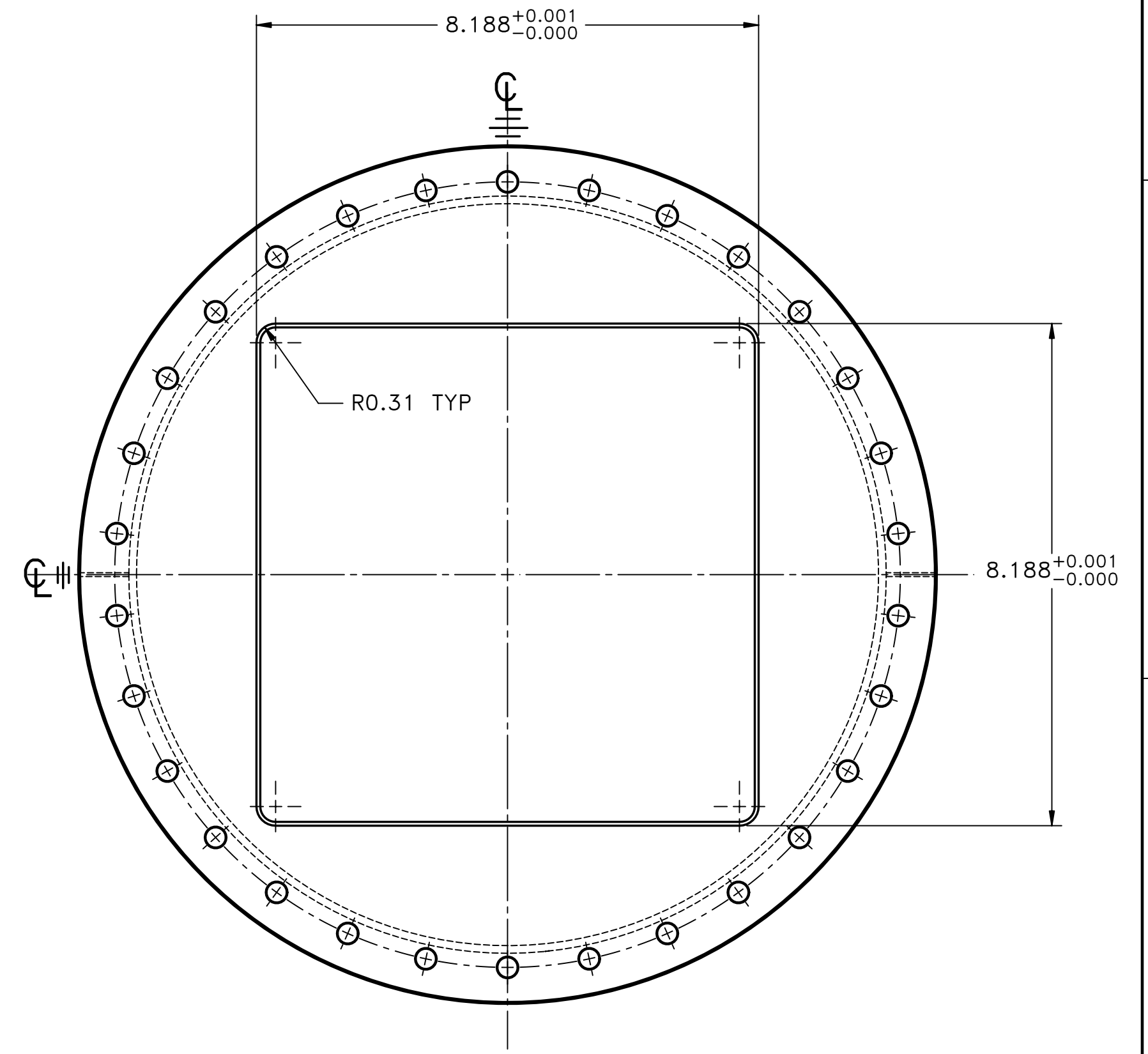

REMOVE ALL BURRS AND SHARP EDGES

TOLERANCES UNLESS OTHERWISE SPECIFIED

DECIMALS	.X	± 0.1
	.XX	± 0.01
	.XXX	± 0.005
ANGULAR		± 1.0°
SURFACE FINISH		125 μ inch

ALL DIMS IN INCHES

REV	DATE	ZONE	REVISION DESCRIPTION	APPROVED
A	5/13/2010		ECO-2165 - Change control applies.	A.G.

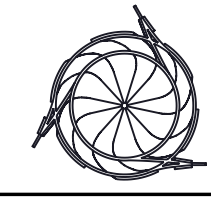

TRIUMF
4004 WESBROOK MALL
VANCOUVER, BRITISH COLUMBIA
CANADA V6T-2A3

CANADA'S NATIONAL LABORATORY FOR
PARTICLE AND NUCLEAR PHYSICS

DO NOT COPY, THIS DOCUMENT
CONTAINS PROPRIETARY INFORMATION

THIS DRAWING, SUBJECT MATTER AND INFORMATION
CONTAINED THEREIN, IS THE SOLE, EXCLUSIVE AND
CONFIDENTIAL PROPERTY OF TRIUMF LABORATORY,
AND AS SUCH, SHALL NOT BE DISCLOSED, COPIED,
REPRODUCED OR USED, IN WHOLE OR IN PART,
WITHOUT EXPRESSED WRITTEN PERMISSION OF THE
TRIUMF LABORATORY OR ITS REPRESENTATIVES.

DESIGNED	A.M.	SUB-ASSY
DRAWN	Daniel Rowbotham	
CHECKED	A.M.	ASSEMBLY
REA #	1030	ILE2313D
TRACKING #		

SCALE	1:4	 THIRD-ANGLE PROJECTION	DWG NO.	ILE2325	SIZE	C	SHEET	1	REV	A
DATE	04-05-10		OF	1						

14" CF MOD, THRU BOLT HOLE, NON ROTATABL
TEXAS AM/TRINAT CHAMBER
LEBT